

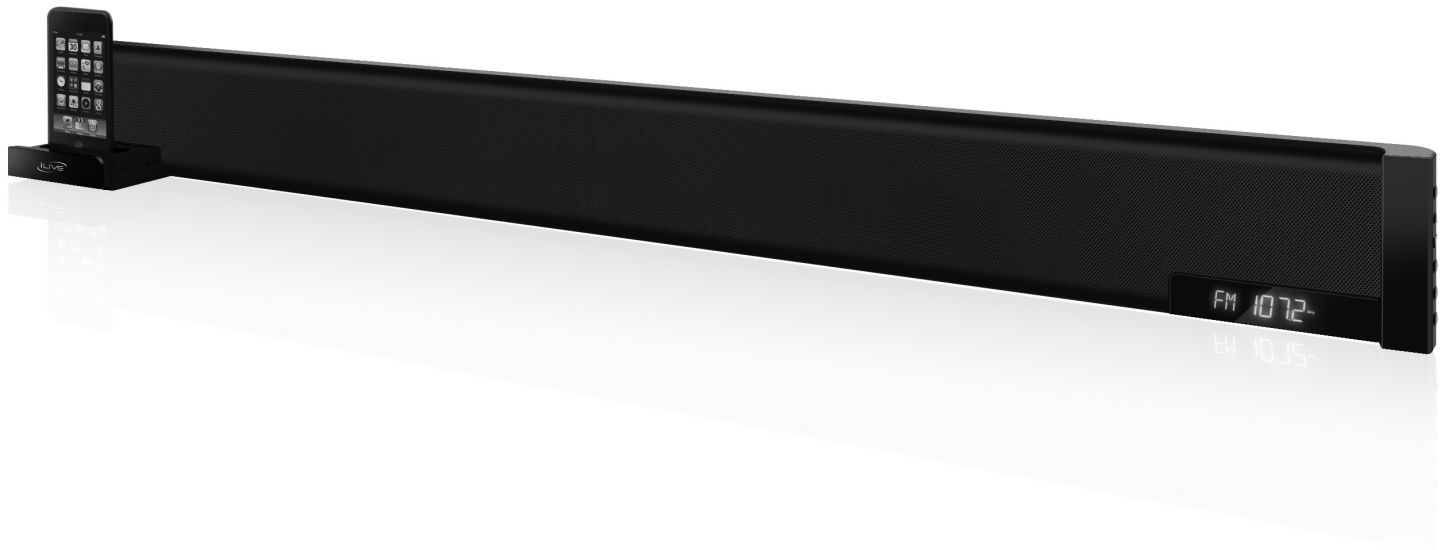

# USER'S GUIDE

V:2149-0511-09



## IT209B

### 3.1 Channel Home Music System with Dock for iPod

For the most up-to-date version of this User's Guide, go to [www.ilive.net](http://www.ilive.net)

## WARNINGS AND PRECAUTIONS

- **CAUTION:** TO PREVENT ELECTRIC SHOCK, MATCH WIDE BLADE OF PLUG TO WIDE SLOT, FULLY INSERT.
- **WARNING:** To prevent fire or shock hazards, do not expose this bar speaker to rain or moisture.
- **CAUTION:** Use of controls or adjustments or performance of procedures other than those specified may result in hazardous radiation exposure.
- **WARNING:** Changes or modifications to this bar speaker not expressly approved by the party responsible for compliance could void the user's authority to operate the equipment.
- **WARNING:** Do not place the bar speaker on top of any soft, porous, or sensitive surfaces to avoid damaging the surface. Use a protective barrier between the bar speaker and surface to protect the surface.
- **WARNING:** Use of this bar speaker near fluorescent lighting may cause interference regarding use of the remote. If the bar speaker is displaying erratic behavior move away from any fluorescent lighting, as it may be the cause.
- **CAUTION:** Danger of explosion if battery is incorrectly replaced. Replace only with the same or equivalent type.
- **PRÉCAUTION:** *Danger d'explosion si les piles sont remplacées de façon incorrect. Remplacer les piles seulement par le même type de pile ou l'équivalent.*
- **WARNING:** There is a danger of explosion if you attempt to charge standard Alkaline batteries in the bar speaker. Only use rechargeable NiMH batteries.
- **WARNING:** The remote control's button cell battery contains mercury. Do not put in the trash, instead recycle or dispose of as hazardous waste
- **WARNING:** Lithium ion batteries, like all rechargeable batteries are recyclable and should be recycled or disposed of in normal household waste. Contact your local government for disposal or recycling practices in your area. They should never be incinerated since they might explode.

Do not mix old and new batteries.

Do not mix alkaline, standard (carbon-zinc), or rechargeable (ni-cad, ni-mh, etc) batteries. *Tum que omante, vid pecesim aximei igingultum pubitere comant. Casta,*

## IMPORTANT SAFETY INSTRUCTIONS

1. Read these Instructions.
2. Keep these Instructions.
3. Heed all Warnings.
4. Follow all instructions.
5. Do not use this apparatus near water.
6. Clean only with a dry cloth.
7. Do not block any ventilation openings. Install in accordance with the manufacturer's instructions.
8. Do not install near any heat sources such as radiators, heat registers, stoves, or other apparatus (including amplifiers) that produce heat.
9. Do not defeat the safety purpose of the polarized or grounding - type plug. A polarized plug has two blades with one wider than the other. A grounding type plug has two blades and a third grounding prong. The wide blade or the third prong are provided for your safety. When the provided plug does not fit into your outlet, consult an electrician for replacement of the obsolete outlet.
10. Protect the power cord from being walked on or pinched particularly at plugs, convenience receptacles, and the point where they exit from the apparatus.
11. Only use attachments/accessories specified by the manufacturer.
12. Use only with a cart, stand, tripod, bracket, or table specified by the manufacturer, or sold with the apparatus. When a cart is used, use caution when moving the cart/apparatus combination to avoid injury from tip-over.
13. Unplug this apparatus during lightning storms or when unused for long periods of time.
14. Refer all servicing to qualified service personnel. Servicing is required when the apparatus has been damaged in any way, such as power-supply cord or plug is damaged, liquid has been spilled or objects have fallen into the apparatus, the apparatus has been exposed to rain or moisture, does not operate normally, or has been dropped.



The lightning flash with arrowhead symbol, within an equilateral triangle, is intended to alert the user to the presence of uninsulated "dangerous voltage" within the product's enclosure that may be of sufficient magnitude to constitute a risk of electric shock to persons.

### CAUTION RISK OF ELECTRIC SHOCK DO NOT OPEN

**WARNING:** TO REDUCE THE RISK OF ELECTRIC SHOCK, DO NOT REMOVE COVER (OR BACK). NO USER-SERVICEABLE PARTS INSIDE. REFER SERVICING TO QUALIFIED SERVICE PERSONNEL.



The exclamation point within an equilateral triangle is intended to alert the user to the presence of important operating and maintenance (servicing) instructions in the literature accompanying the appliance.



This product utilizes a Class 1 laser to read Compact Discs. This laser Compact Disc Player is equipped with safety switches to avoid exposure when the CD door is open and the safety interlocks are defeated. Invisible laser radiation is present when the CD Player's lid is open and the system's interlock has failed or been defeated. It is very important that you avoid direct exposure to the laser beam at all times. Please do not attempt to defeat or bypass the safety switches.

### FCC Warnings

NOTE: This equipment has been tested and found to comply with the limits for a Class B digital device, pursuant to Part 15 of the FCC Rules. These limits are designed to provide reasonable protection against harmful interference in a residential installation. This equipment generates, uses, and can radiate radio frequency energy and, if not installed and used in accordance with the instructions, may cause harmful interference to radio communications. However, there is no guarantee that interference will not occur in a particular installation. If this equipment does cause harmful interference to radio or television reception, which can be determined by turning the equipment off and on, the user is encouraged to try to correct the interference by one or more of the following measures:

- Reorient or relocate the receiving antenna.
- Increase the separation between the equipment and receiver.
- Connect the equipment into an outlet on a circuit different from that to which the receiver is connected.
- Consult the dealer or an experienced radio/TV technician for help.

### Additional Warnings

- The apparatus shall not be exposed to dripping or splashing and that no objects filled with liquids, such as vases, shall be placed on apparatus. *L'appareil ne doit pas être exposé aux écoulements ou aux éclaboussures et aucun objet ne contenant de liquide, tel qu'un vase, ne doit être placé sur l'objet.*
- Main plug is used as disconnect device and it should remain readily operable during intended use. In order to disconnect the apparatus from the mains completely, the mains plug should be disconnected from the mains socket outlet completely. *La prise du secteur ne doit pas être obstruée ou doit être facilement accessible pendant son utilisation. Pour être complètement déconnecté de l'alimentation d'entrée, la prise doit être débranchée du secteur.*
- Battery shall not be exposed to excessive heat such as sunshine, fire or the like. *Les piles ne doivent pas être exposées à de forte chaleur, tel qu'à la lumière du soleil, au feu ou autres choses de semblable.*
- Caution marking is located at the bottom of apparatus. *Les précautions d'emploi sont inscrites en bas de l'appareil.*
- The marking information is located at the bottom of apparatus. *Les marquages sont inscrits en bas de l'appareil.*



**CONTENTS**

**WARNINGS AND PRECAUTIONS** 2  
**CONTENTS & COMPANY INFORMATION** 3  
 GREEN INITIATIVE ..... 3  
 INTERNATIONAL SUPPORT ..... 3  
 SERVICE INFORMATION ..... 3  
**QUICK START** 4  
 POWER THE BAR SPEAKER ..... 4  
**PLAYING AN IPOD** 4  
**QUICK START** 5  
 POWER THE BAR SPEAKER ..... 5  
**CONNECTING AUDIO FROM A TV TO THE BAR SPEAKER** 5  
**CONNECTING VIDEO FROM THE BAR SPEAKER TO A TV** 5  
**CONNECTING A DVD PLAYER TO THE BAR SPEAKER** 5  
**PRODUCT INFORMATION** 6  
 ACCESSORIES ..... 6  
**PRODUCT INFORMATION & POWER OPTIONS** 7  
 FEATURES ..... 7  
 DIMENSIONS ..... 7  
 AC POWER ..... 7  
 REMOTE POWER ..... 7  
**INSTALLATION** 8  
 BAR SPEAKER PLACEMENT ..... 8  
**INSTALLATION** 9  
 MOUNTING THE BAR SPEAKER ONTO A WALL ..... 9  
**CONNECTIVITY** 10  
**CONNECTIVITY** 11  
 CONNECTING A TELEVISION TO THE BAR SPEAKER ..... 11  
 AUDIO TO THE BAR SPEAKER ..... 11  
 S-VIDEO FROM THE BAR SPEAKER ..... 11  
 COMPOSITE VIDEO FROM THE BAR SPEAKER ..... 11  
**CONNECTIVITY** 12  
 CONNECTING A DVD PLAYER TO THE BAR SPEAKER ..... 12  
 AUDIO ..... 12  
 COMPOSITE VIDEO ..... 12  
**IPOD OPERATIONS** 13  
 DOCKING AN IPOD ..... 13  
 PLAYING AN IPOD ..... 13  
**RADIO OPERATIONS** 14  
 AM LOOP ANTENNA ..... 14  
 FM WIRE ANTENNA ..... 14  
 TUNING THE AM/FM RADIO ..... 14  
 SAVING RADIO STATIONS ..... 14  
 SELECTING A SAVED RADIO STATION ..... 14  
**MISCELLANEOUS OPERATIONS** 15  
 BUILT IN SOUND TECHNOLOGIES ..... 15  
 FOR AUDIO ..... 15  
 CONNECTING AN EXTERNAL SUBWOOFER ..... 15  
 RESETTING THE BAR SPEAKER ..... 15  
**CONTROLS & CONTROL GLOSSARY** 16-23

**GREEN INITIATIVE**

**Environmental Commitment to ‘Protect for Today and Sustain for Tomorrow’**

2009 marks the official launch of DPI, Inc.’s corporate campaign for a greener and cleaner world. DPI is building upon environmental initiatives introduced at all of their facilities to help formulate and sustain significant and important conservation efforts within its manufacturing and marketing commbar speakeries. In addition to targeting and selecting energy efficient product features, and structuring ‘green office’ procedures, other initial program efforts include:

- Reduction of all packaging sizes
- Recyclable plastics for clamshell packages, with a plan to eventually replace plastic with recyclable paper
- Recycled fiber board in place of the polyfoam in packing boxes
- Recycled plastics in place of the virgin material in product construction

**INTERNATIONAL SUPPORT**

To download this User’s Guide in English, Spanish, or French, visit the support section at [www.ilive.net](http://www.ilive.net).

Para transferir esta guía de usuario en inglés, español, o francés, visite la sección de la ayuda en [www.ilive.net](http://www.ilive.net).

Pour télécharger ce guide de l’utilisateur en anglais, espagnol, ou français, visitez la section de soutien chez [www.ilive.net](http://www.ilive.net).

**SERVICE INFORMATION**

Address: 2116 Carr Street, St. Louis MO, 63106

Phone: 1-314-621-2881

Fax: 1-314-588-1805

Email: [customerservice@ilive.net](mailto:customerservice@ilive.net)

Parts Email: [partsinfo@dpi-global.com](mailto:partsinfo@dpi-global.com)

Website: [www.ilive.net](http://www.ilive.net)

## QUICK START

### POWER THE BAR SPEAKER

1. Connect the bar speaker to AC power source using the attached AC Power Cord.

### PLAYING AN IPOD

1. Locate the numbered bracket that fits the iPod that will be docked.

*Each included Bracket has a number on it, indicating which iPod model that bracket is compatible with.*

- *See the separate bracket chart page to identify which bracket is needed.*
2. Press the **Power Button** to turn the bar speaker on.
  3. Press the **Source Button** to switch to *iPod Mode*.
  4. Press the **iPod Drawer Button**, on the left side of the bar speaker, to open the motorized dock for iPod.
  5. Snap the bracket into place over the **iPod Connector** in the dock.
  6. Connect the iPod to the **iPod Connector** inside the dock.
  7. After the iPod is docked, the bar speaker is powered on, and the bar speaker is in *iPod Mode*, press the **Play/Pause Button** on the remote to begin playing the docked iPod.

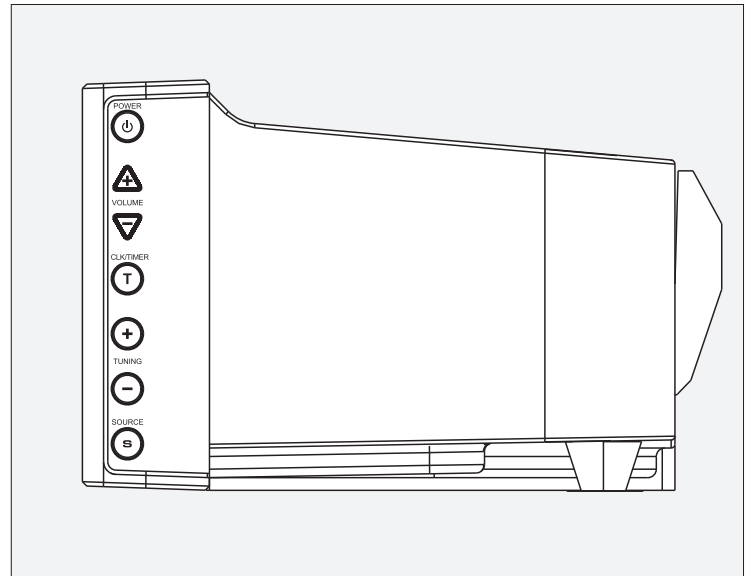
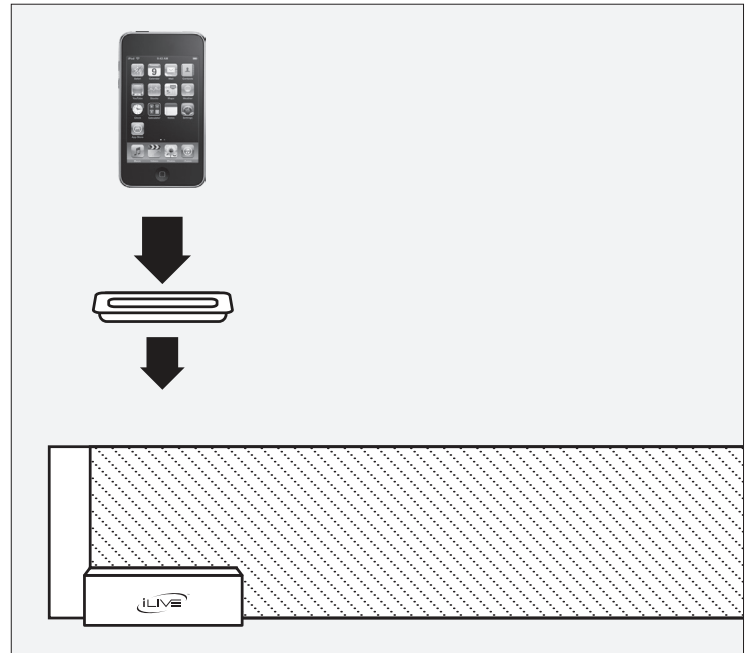

## POWER THE BAR SPEAKER

1. Connect the bar speaker to AC power source using the attached AC Power Cord.

### CONNECTING AUDIO FROM A TV TO THE BAR SPEAKER

1. Connect a *Stereo RCA Cable* to the *Audio Outputs* on the television.
2. Connect the other end of the *Stereo RCA Cable* to the **Auxiliary Stereo Inputs** on the bar speaker.

*The volume on your television may need to be adjusted independently of the bar speaker, or adjusted to a fixed audio mode.*

### CONNECTING VIDEO FROM THE BAR SPEAKER TO A TV

1. Connect an *RCA Video Cable* to the *Video Input* on the television.
2. Connect the other end of the *RCA Video Cable* to the **Video Output** on the bar speaker.

### CONNECTING A DVD PLAYER TO THE BAR SPEAKER

1. Connect a *Stereo RCA Cable* to the *Audio Outputs* on the device.
2. Connect the other end of the *Stereo RCA Cable* to the **AV 1 R** and **AV1 L Stereo Inputs** on the bar speaker.
3. Connect an *RCA Video Cable* to the *Video Output* on the DVD Player.
4. Connect the other end of the *RCA Video Cable* to the **Video 1 Input** or the **Video 2 Input** on the bar speaker.

*The numbered Video Inputs need to correspond with the connected Audio Inputs.*

*The bar speaker itself has no video display. In order to view video from a connected DVD Player, the bar speaker must be connected to a television by using the **Composite Video Output**.*

*The S-Video Output will not output video from a connected DVD Player. The S-Video Output will only output video from a docked iPod.*

#### SPECIAL NOTE:

*A Digital Cable or Satellite Tuner, Set-Top Box, Gaming Console, or VCR can be connected to the bar speaker in the same way that a DVD Player is connected.*

Example of Television Inputs & Outputs

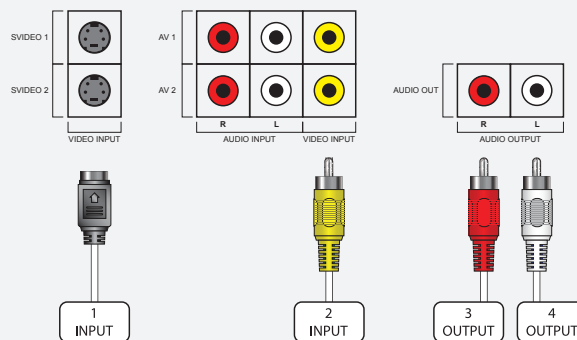
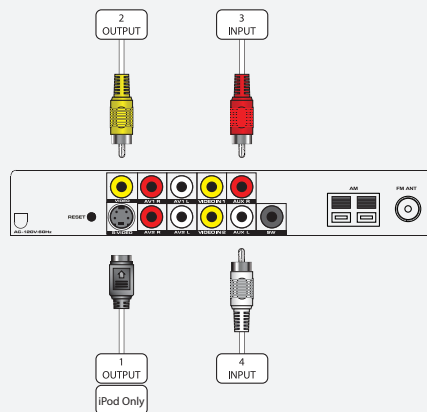

Diagram of the IT209's Inputs & Outputs



Example of DVD Player Outputs

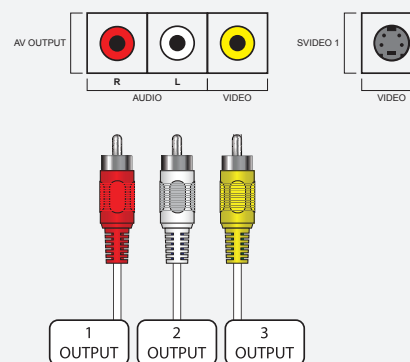
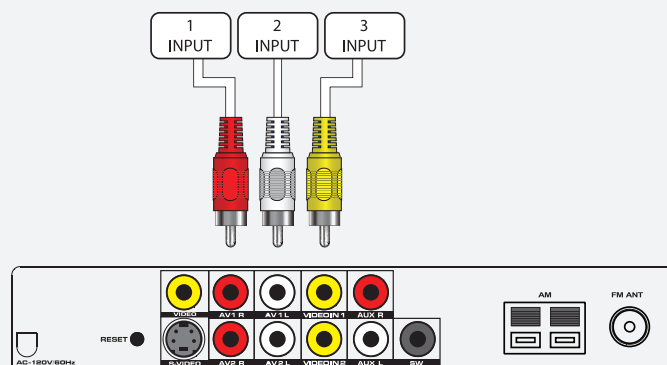

Diagram of the IT209's Inputs & Outputs



# PRODUCT INFORMATION

## ACCESSORIES

AM Loop Antenna

FM Wire Antenna

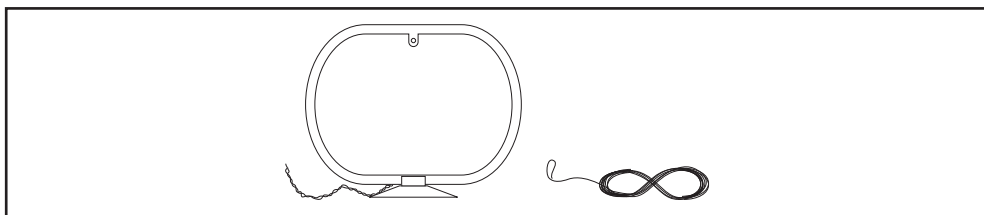

(4) Docking Brackets for iPod

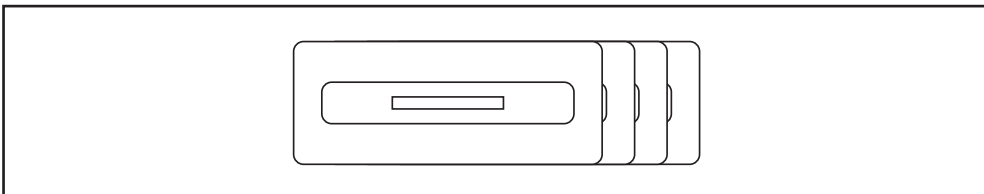

Remote Control

(2) AAA Batteries for Remote

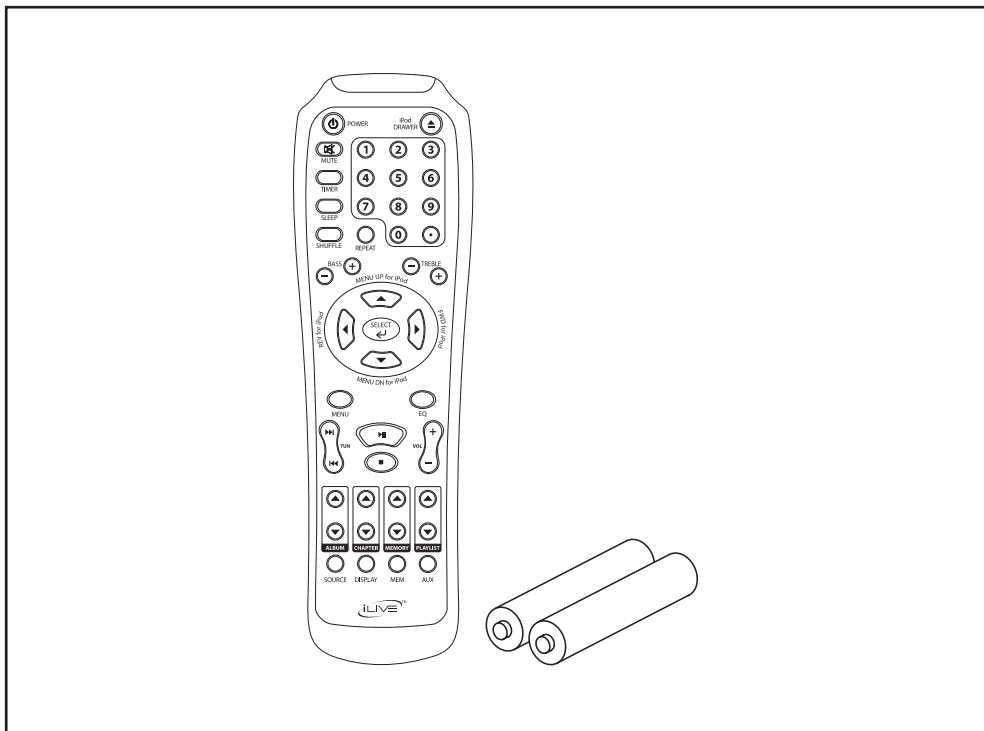

(2) Wall Mount Brackets

(4) Long Screws

(4) Short Screws

(2) 1/4" Spacers

(2) 1/2" Spacers

(2) 3/4" Spacers

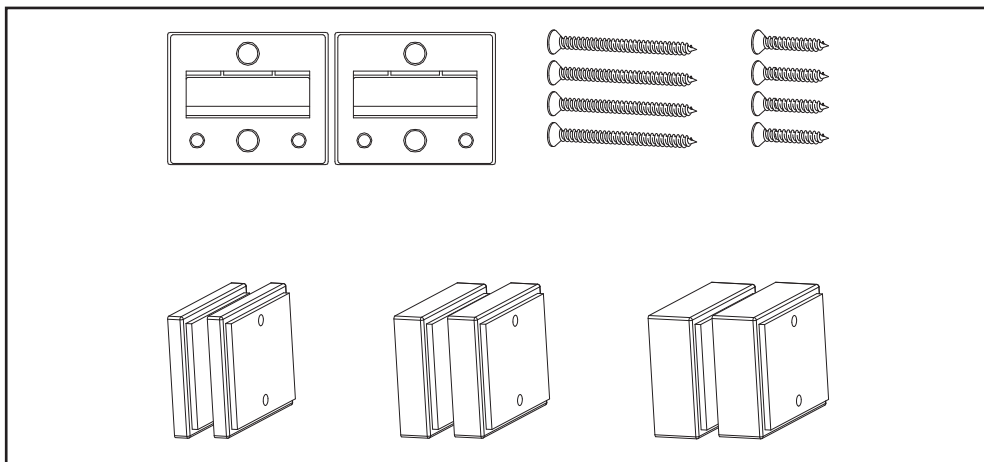

**FEATURES**

**Dock plays and charges iPod**

**3.1 channel speaker system with simulated 5.1 system**

**AM/FM radio with digital tuning**

Remote Control

RCA stereo input

Auxiliary input for iPod shuffle and other audio devices

Composite video input (2)

Integrated subwoofer output

S-Video Output for iPod

Composite Video Output for DVD Player and iPod

SRS TruSurround XT™

Preset EQ settings

Electronic volume, treble, and bass controls

Motorized iPod docking drawer

Wall mountable

Integrated subwoofer

Station memory presets 10 AM and 20 FM and last channel memory

Digital clock with adjustable sleep timer

Direct access radio station tuning

AC power: built-in AC cord

**DIMENSIONS**

Length: 37"

Height: 3.3"

Width: 6"

**AC POWER**

Connect the bar speaker to AC power source using the attached AC Power Cord.

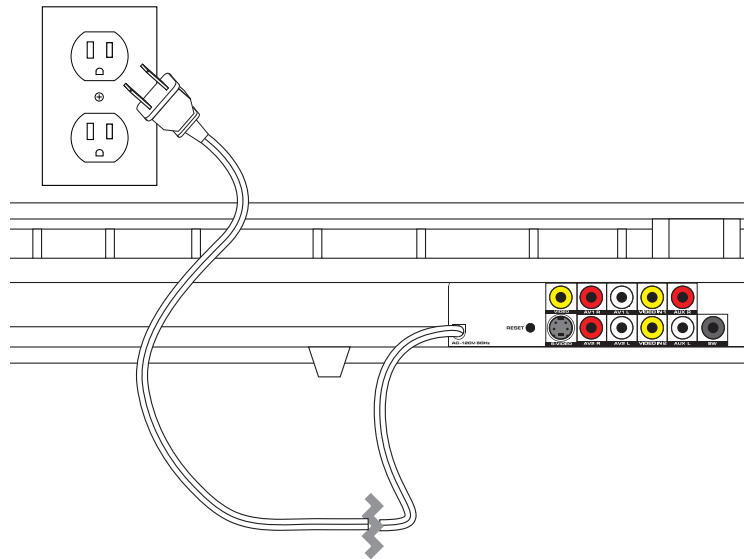

**REMOTE POWER**

Load the included AAA Batteries into the remote to power the remote.

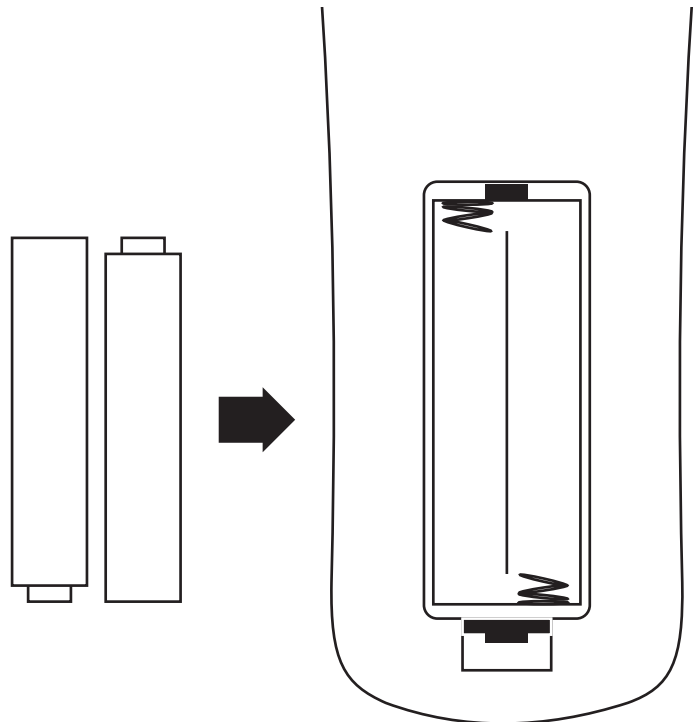



## BAR SPEAKER PLACEMENT

The bar speaker depends, in part, on its environment to help produce a realistic surround sound environment. We've suggested two potential placement options in the diagrams below to help you get the most out of your 3.1 Channel Music System.

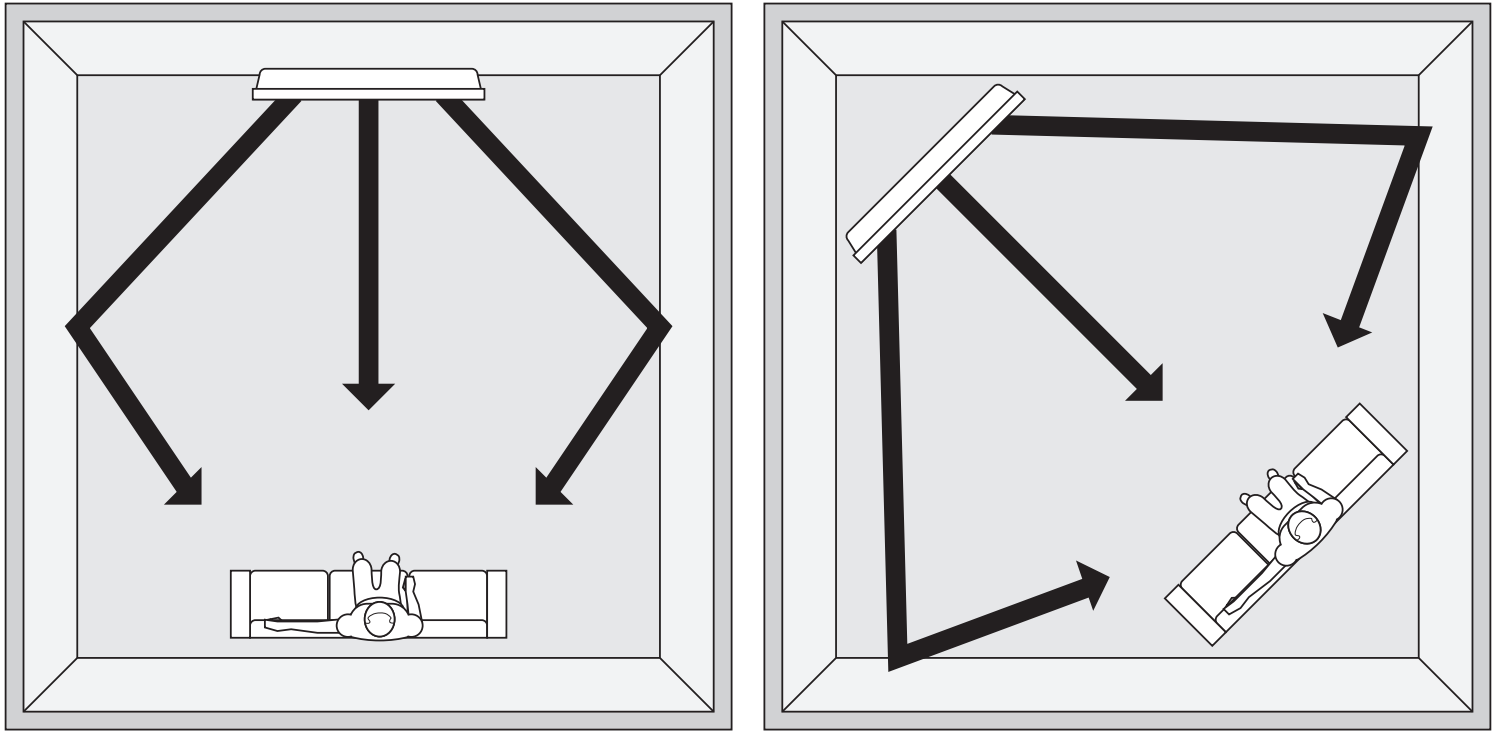

When placing the bar speaker on an entertainment center, bookshelf, or any type of enclosed space, be sure to allow at least 2-3 inches of space around the bar speaker for ventilation. If the bar speaker is enclosed in a tight space, without ventilation, heat generated from the bar speaker could produce a potential heat hazard.

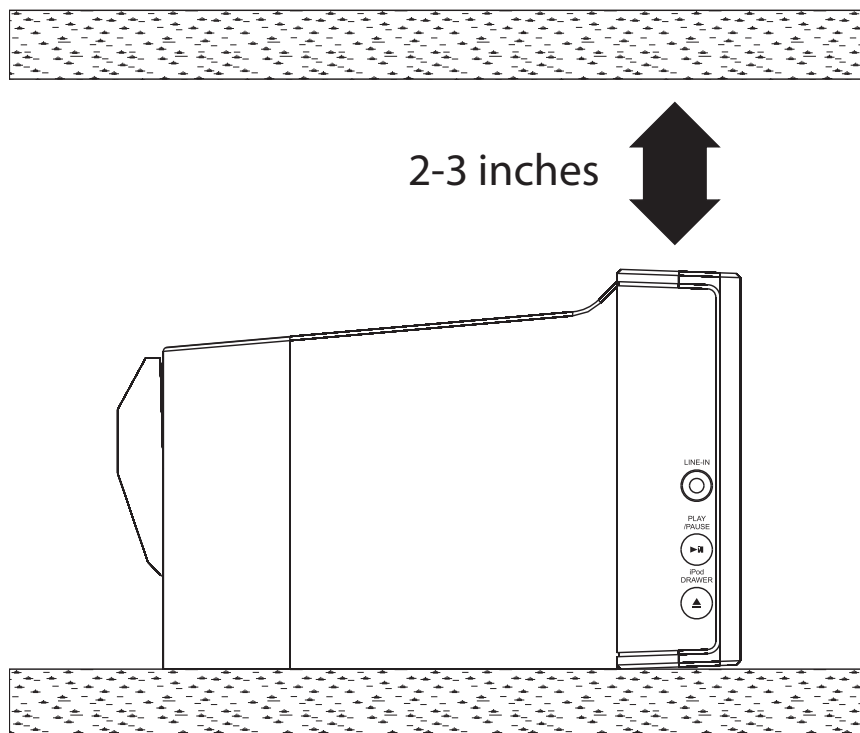



## MOUNTING THE BAR SPEAKER ONTO A WALL

- *We recommend having this bar speaker professionally mounted.*

By using the included wall mounting accessories, the bar speaker can be mounted onto a wall.

The included spacers should be used at your discretion to extend the face of the bar speaker farther from the wall. These are typically used when mounting the bar speaker under a television, and the face of the bar speaker needs to be flush with the face of the television.

### Required Tools

- Manual or Power Screwdriver
- Stud Finder
- Pencil
- Tape Measure
- Level

### Getting Started

1. Use the Tape Measure to decide how high you'd like to hang the bar speaker on the wall.

*The bar speaker must be hung within 6 feet of an AC power outlet for the attached AC Power Cord to reach.*

2. Use the Stud Finder to locate 2 parallel wooden studs to screw the mounting brackets into.
3. Mark the wall at the center of the studs using the pencil.
4. Line the level up on both of your marks to make sure they are level. If they're not, adjust the marks as needed to make them level.
5. After you've double checked your markings, drill through the top hole on both mounting brackets directly into the marks you've made on the wall.

*If you are using the brackets only and no spacers, use the included short screws. If you are using any of the spacers or combination of the spacers, use the long screws.*

6. Use the Level to level each of the hanging brackets, then drill the second screw into the bottom hole on both mounting brackets.
7. Slide the bar speaker onto the mounting brackets, and make sure there is a firm and stable connection before letting go of the bar speaker.
8. Finally, use the Level to confirm that the bar speaker is level.

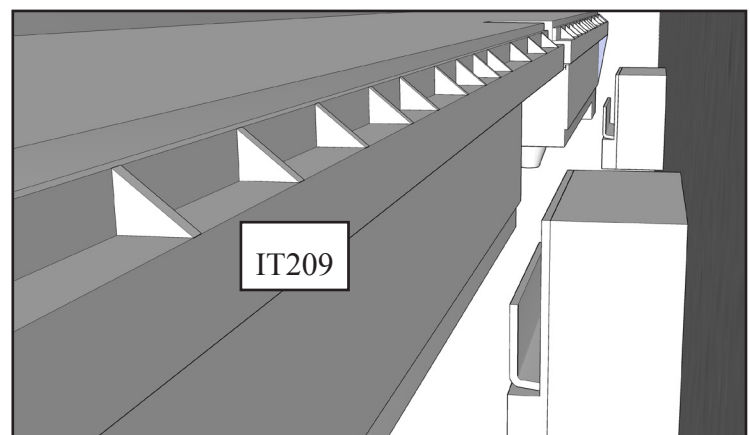
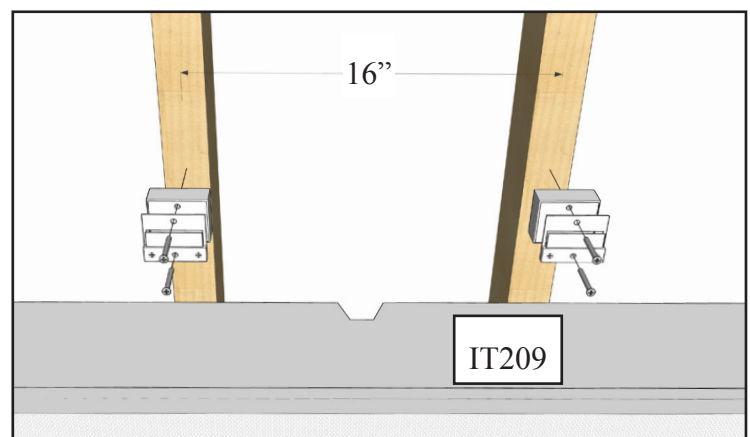
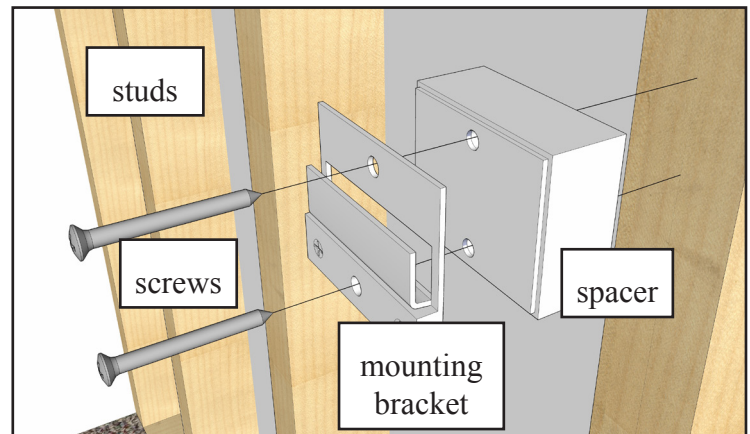



### CONNECTING A TELEVISION TO THE BAR SPEAKER

When connecting a television to the bar speaker, is outputting the audio from the television to the bar speaker, the bar speaker will provide you with a higher quality audio output than your television.

### AUDIO TO THE BAR SPEAKER

1. Connect a *Stereo RCA Cable* to the *Audio Outputs* on the television.
2. Connect the other end of the *Stereo RCA Cable* to the **Auxiliary Stereo Inputs** on the bar speaker.

*The volume on your television may need to be adjusted independently of the bar speaker, or adjusted to a fixed audio mode.*

### S-VIDEO FROM THE BAR SPEAKER

1. Connect an *S-Video Cable* to the *S-Video Input* on the television.
2. Connect the other end of the *S-Video Cable* to the **S-Video Output** on the bar speaker.

*The S-Video Output will not output video from a connected DVD Player. The S-Video Output will only output video from a docked iPod.*

### COMPOSITE VIDEO FROM THE BAR SPEAKER

1. Connect an *RCA Video Cable* to the *Video Input* on the television.
2. Connect the other end of the *RCA Video Cable* to the **Video Output** on the bar speaker.

Example of Television Inputs & Outputs

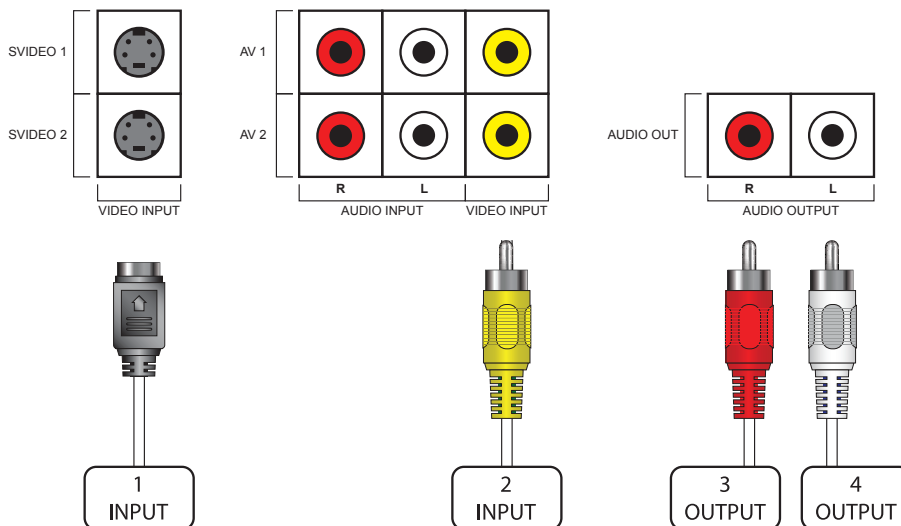
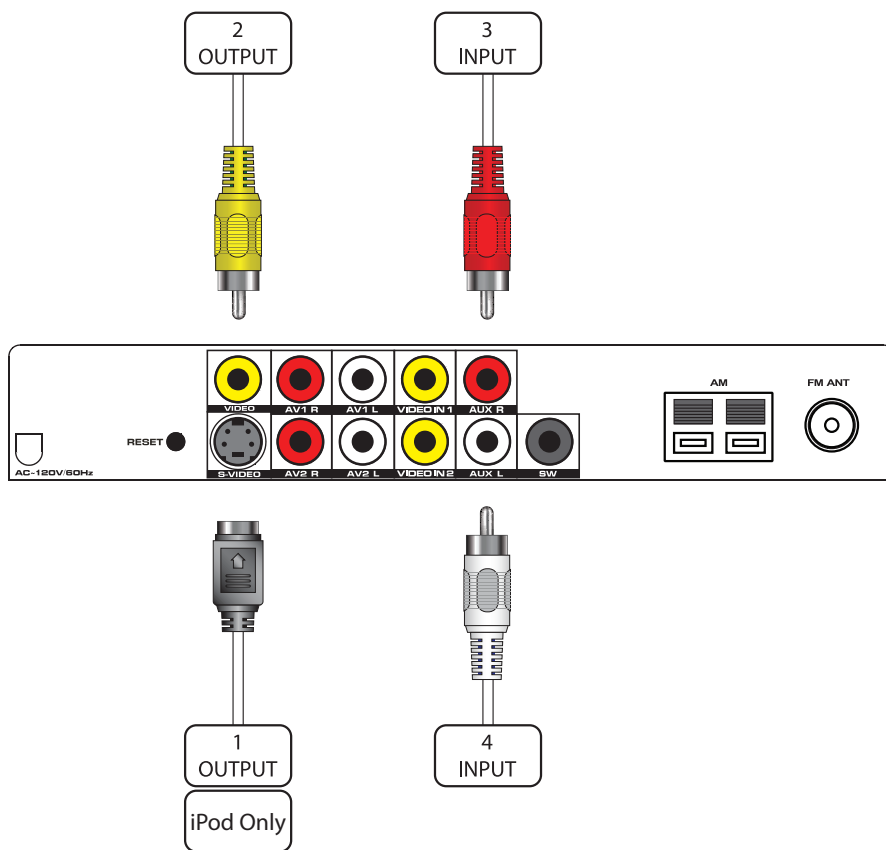

Diagram of the IT209's Inputs & Outputs



CONNECTING A DVD PLAYER TO THE BAR SPEAKER

When connecting a DVD Player to the bar speaker, outputting the audio from the device to the bar speaker, and outputting video from the device either directly to the television or to the television through the bar speaker. These instructions will show you how to connect the device to the television by going through the bar speaker

Example of DVD Player Outputs

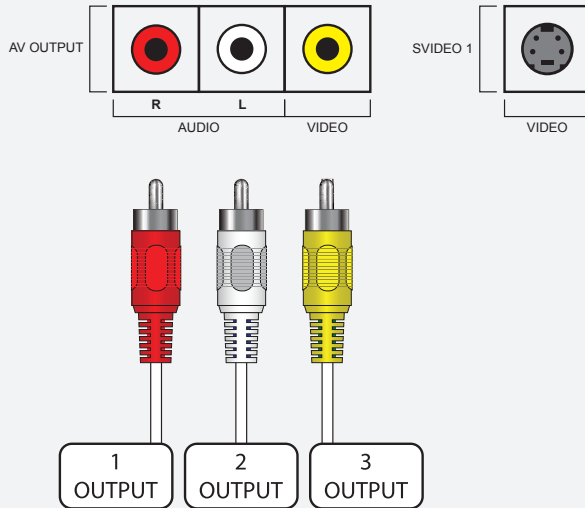
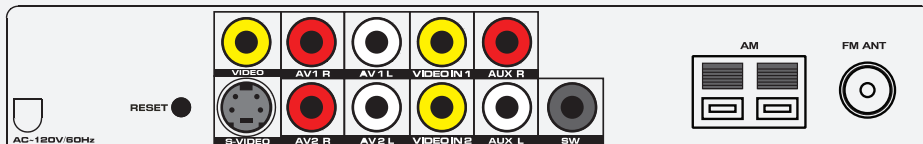
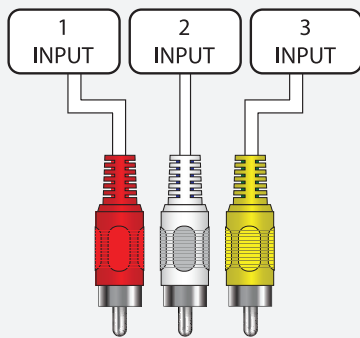

Diagram of the IT209's Inputs & Outputs



AUDIO

1. Connect a *Stereo RCA Cable* to the *Audio Outputs* on the device.
2. Connect the other end of the *Stereo RCA Cable* to the **AV 1 R** and **AV1 L Stereo Inputs** on the bar speaker.

COMPOSITE VIDEO

1. Connect an *RCA Video Cable* to the *Video Output* on the DVD Player.
2. Connect the other end of the *RCA Video Cable* to the **Video Input** on the bar speaker.

*The bar speaker itself has no video display. In order to view video from a connected DVD Player, the bar speaker must be connected to a television.*

*The S-Video Output will not output video from a connected DVD Player. The S-Video Output will only output video from a docked iPod.*

SPECIAL NOTE:

*A Digital Cable or Satellite Tuner, Set-Top Box, Gaming Console, or VCR can be connected to the bar speaker in the same way that a DVD Player is connected.*

## DOCKING AN IPOD

1. Locate the numbered bracket that fits the iPod that will be docked.

*Each included Bracket has a number on it, indicating which iPod model that bracket is compatible with.*

- *See the separate bracket chart page to identify which bracket is needed.*
2. Press the **Power Button** to turn the bar speaker on.
  3. Press the **Source Button** to switch to *iPod Mode*.
  4. Press the **iPod Drawer Button** on the left side of the unit to open the motorized dock for iPod.
  5. Snap the bracket into place over the **iPod Connector** in the dock.
  6. Connect the iPod to the **iPod Connector** inside the dock.

*When the bar speaker is plugged in, using AC power, the docked iPod will charge.*

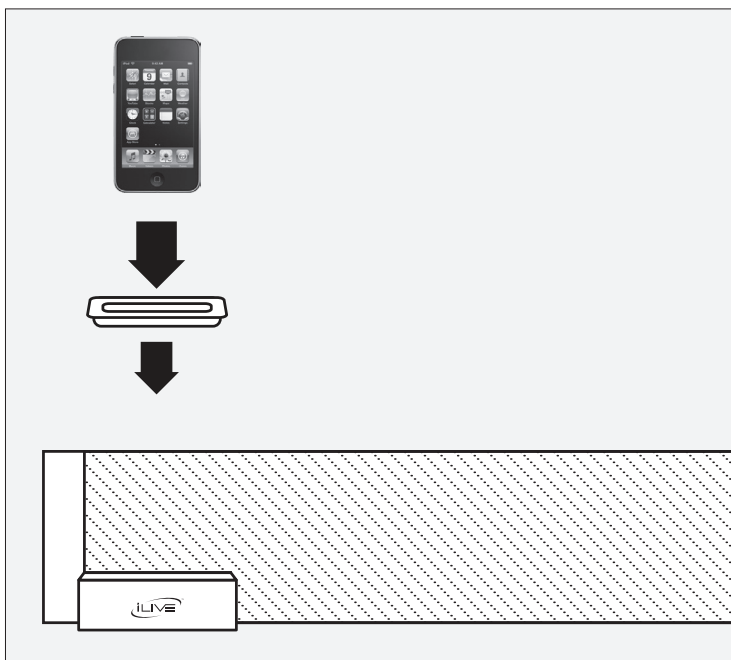

## PLAYING AN IPOD

1. Follow the Steps for Docking an iPod.
2. After the iPod is docked, the bar speaker is powered on, and the bar speaker is in *iPod Mode*, press the **Play/Pause Button** on the remote to begin playing the docked iPod.
  - Press the **Play/Pause Button** on the remote to pause a docked iPod during play.
  - Press the **Tuning Buttons** to skip between tracks or chapters on a docked iPod.
  - Press and hold the **Tuning Buttons** to search an individual track or chapter on a docked iPod.
  - Press the **Shuffle Button** on the remote to activate the shuffle mode on a docked iPod. When in shuffle mode, the docked iPod will play the current album or playlist in a random order.

Press the **Shuffle Button** again to deactivate the shuffle mode.

- Press the **Menu Up for iPod** and **Menu Down for iPod Buttons** on the remote to move up and down in any of the menus on a docked iPod.

*The Reverse & Fast Forward for iPod Buttons work exactly like the “Rewind” and “Fast-forward” Buttons on an iPod.*

- Press the **Menu Button** on the remote to go to the previous menu on a docked iPod.

*The Menu Button on the bar speaker works exactly like the “Menu” Button on an iPod.*

- Press the **Album Buttons** on the remote to cycle through albums on a docked iPod.
- Press the **Repeat Button** on the remote to repeat tracks, chapters, albums and playlists, or movies on a docked iPod.

*Press Once:* Repeat the current track or chapter.

*Press Twice:* Repeat the current album, playlist, or movie.

*Press Three Times:* Turn the repeat off.

## RADIO OPERATIONS

Before playing the FM or AM radio on the bar speaker, connect the included AM and FM antennas to ensure reliable radio reception.

### AM LOOP ANTENNA

1. Remove the small rubber wire protector from the ends of the wires on the included AM Loop Antenna.
2. Press the black buttons on the AM Antenna Connection to open the antenna connection.
3. Insert the exposed AM antenna wires into the openings on the AM Antenna Connection.

*After releasing the black buttons, the AM Antenna Connection should have a firm hold on the exposed wires. If the connection feels loose, or you aren't getting good AM radio reception, repeat steps 2 and 3.*

### FM WIRE ANTENNA

1. Insert the plug on the FM Wire Antenna into the FM Antenna Connection.
2. Extend and adjust the FM Wire Antenna, after connecting it, to adjust or improve FM radio reception.

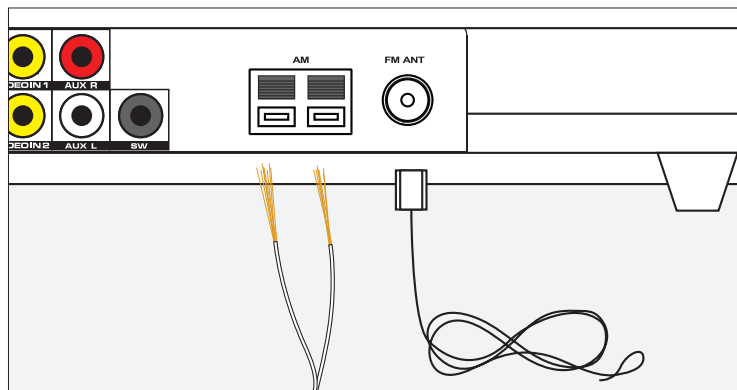

### TUNING THE AM/FM RADIO

1. Press the **Power Button** to turn the bar speaker on.
2. Press the **Source Button** to switch to *FM Radio Mode* or *AM Radio Mode*.
3. Press the **Tuning Buttons** to adjust the AM or FM radio frequency.
  - Press and hold the **Tuning Buttons** to scan for the next available AM or FM radio frequency.

### SAVING RADIO STATIONS

1. Tune the AM or FM radio to the desired station.
2. Press the **Mem Button** on the remote.
3. Press the **Menu Up for iPod** and **Menu Down for iPod Buttons** on the remote to select a memory slot.
4. Press the **Mem Button** on the remote to save the current AM or FM radio station to the selected memory slot.

### SELECTING A SAVED RADIO STATION

1. In *FM Radio Mode*, press the **Memory Buttons** on the remote to cycle through saved FM radio stations.
2. In *AM Radio Mode*, press the **Memory Buttons** on the remote to cycle through saved AM radio stations.

## BUILT IN SOUND TECHNOLOGIES

If you press the **EQ Button** on the remote, you can cycle through the available sound technologies that are built into the bar speaker.

### FOR AUDIO

- **SRS TruSurround XT®** creates a truly immersive surround sound experience with rich bass and clear dialog.
- **SRS TruSurround XT® - Dialog Clarity Mode** enhances the vocals so dialog is clear and easy to understand.
- **SRS WOW®** significantly improves the playback quality of audio, delivering a dynamic 3D entertainment experience with deep, rich bass.
- **Music 2.1** delivers the audio through two of the three speakers and the subwoofer.
- **Music 3.1** delivers the audio through all three of the bar speaker's speakers and the subwoofer.



## CONNECTING AN EXTERNAL SUBWOOFER

*Requires an RCA Audio Cable.*

1. Plug an RCA Audio Cable into the **Subwoofer Output** on the bar speaker.
2. Connect the other end of the RCA Audio Cable into an external Subwoofer.

*The connected external subwoofer will amplify the lower audio frequency output from the bar speaker.*

## RESETTING THE BAR SPEAKER

If the bar speaker is not responding correctly, try resetting it.

1. Using a paperclip or like object, press the **Reset Button** on the back of the bar speaker. This will restore the bar speaker to its default settings.

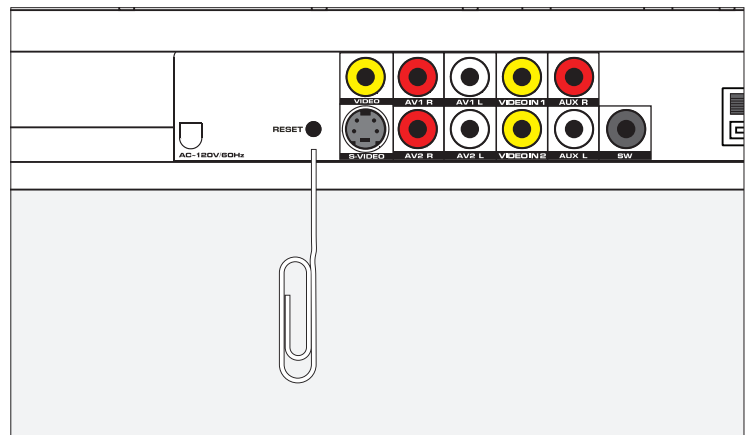



## CONTROLS - SIDES OF THE BAR SPEAKER

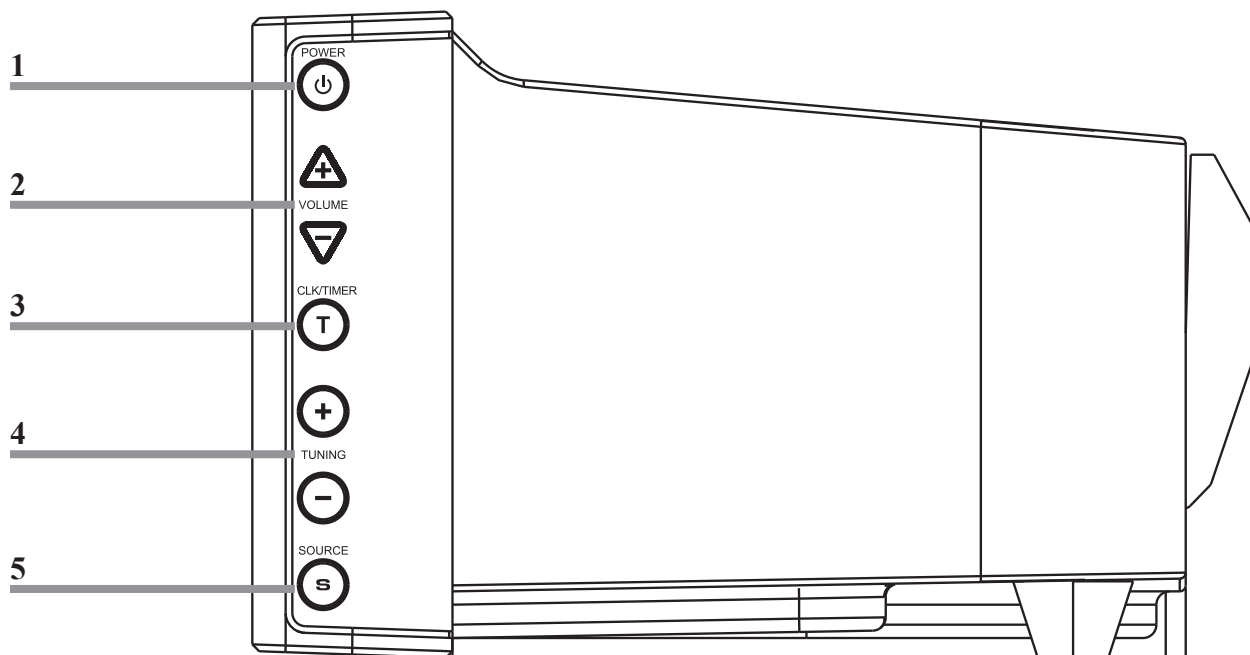

## CONTROL GLOSSARY

### 01. Power Button

Press the Power Button to turn the bar speaker off and on.

*Please note, the bar speaker must be plugged into a power source in order for the bar speaker to be turned on.*

### 02. Volume Buttons

Press the Volume Buttons to adjust the volume of the bar speaker.

*Please be responsible when adjusting the volume level of the bar speaker. If the volume is set too high, the audio output from the bar speaker could damage your hearing. Keep the volume in the moderate to low range.*

### 03. Clock/Timer Button

With the bar speaker powered off, press and hold the Clock Button to set the bar speaker's clock.

With the bar speaker powered on, press and hold the Timer Button to set the bar speaker's timer.

With the bar speaker powered off, press the Timer Button to activate or deactivate the timer.

*Press the **Tuning Buttons** to adjust the hour and minute when setting the Clock or Timer.*

### 04. Tuning Buttons

Press the Tuning Buttons to adjust the AM or FM radio frequency.

Press and hold the Tuning Buttons to scan for the next available AM or FM radio frequency.

### 05. Source Button

Press the Source Button to switch between the bar speaker's different modes, and to cycle through the different audio and video inputs.

#### Modes

- **iPod Mode**  
Switch to iPod Mode to amplify and control a docked iPod.
- **FM Radio Mode**  
Switch to FM Radio Mode to play the FM Radio.
- **AM Radio Mode**  
Switch to AM Radio Mode to play the AM Radio.

#### Audio & Video Inputs

- **AV1** - Plays the source connected to the Audio and Video 1 inputs.
- **AV2** - Plays the source connected to the Audio and Video 2 inputs.
- **Aux** - Plays the source connected to the Auxiliary Audio Inputs.
- **Line** - Plays the source connected to the Line Input.

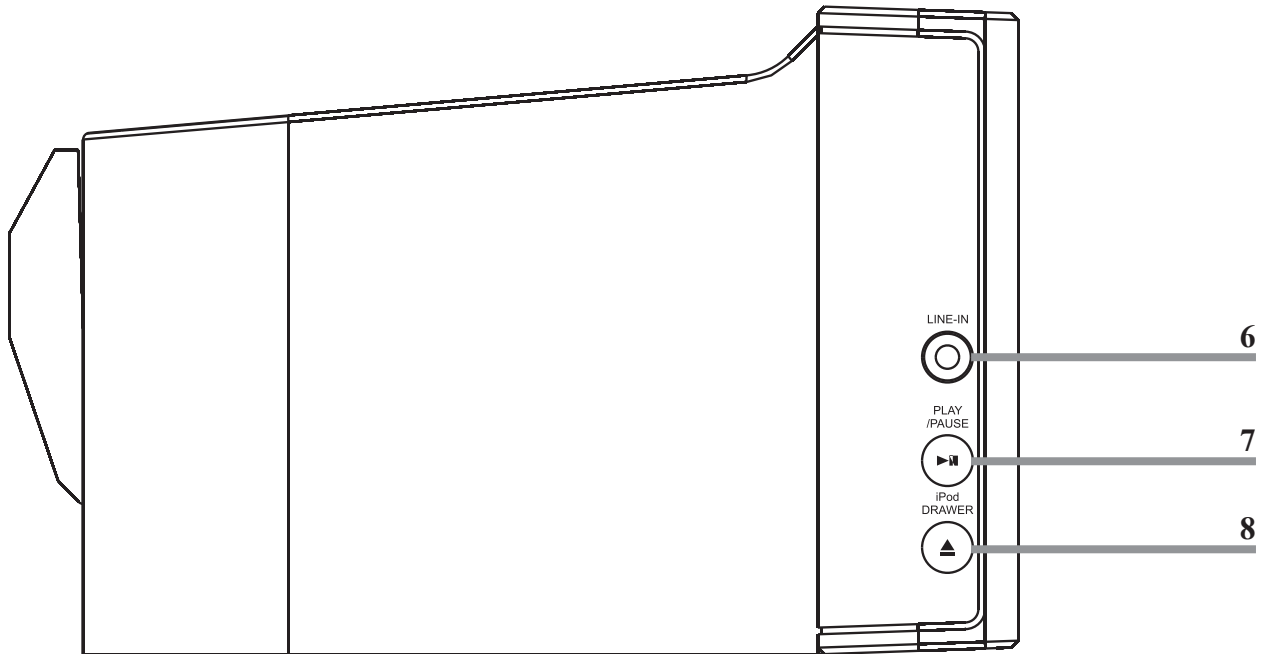

## CONTROL GLOSSARY

**06. Line Input**

Use the Line Input to connect an MP3 Player, such as an iPod Shuffle, or another Audio Source.

*Any device with a headphone jack, line output, or auxiliary output can be connected to the Line Input.*

**07. Play/Pause Button**

Press the Play Button to play a docked iPod.

Press the Pause Button to pause a docked iPod while playing.

**08. iPod Drawer Button**

Press the iPod Drawer Button to open or close the motorized dock for iPod.

## CONTROLS - BACK OF THE BAR SPEAKER

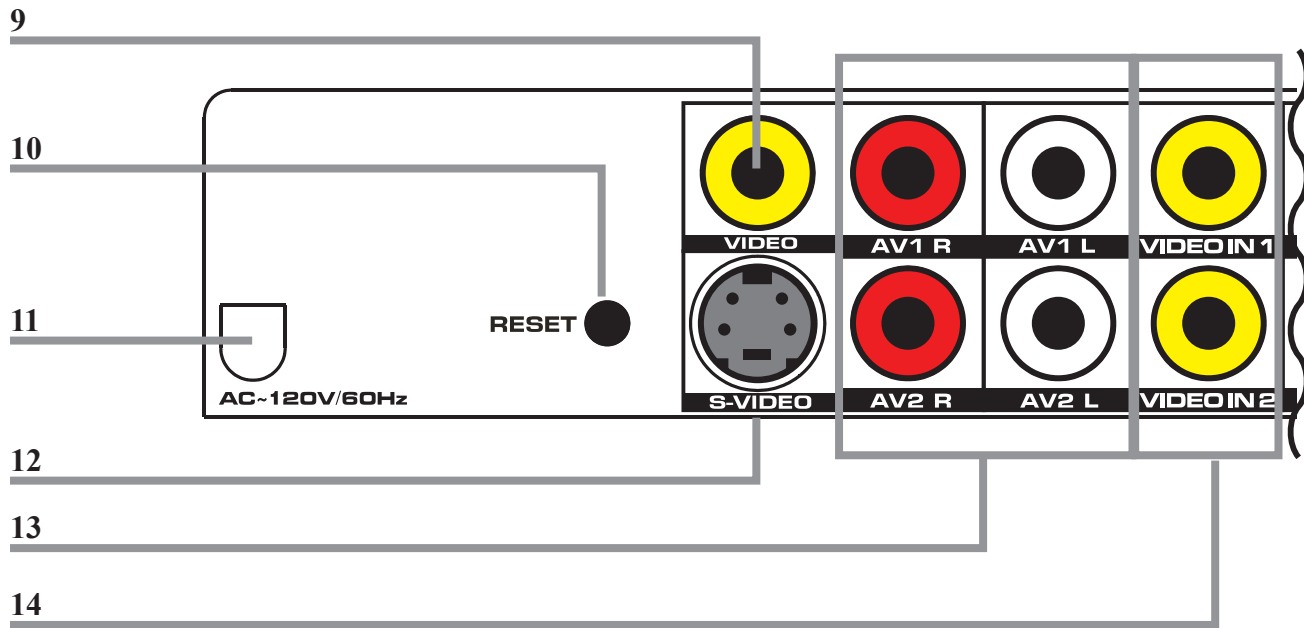

## CONTROL GLOSSARY

### 09. Video Output (iPod and DVD Player)

*Requires a Composite RCA Video Cable.*

Use the Video Output to output video from a docked iPod or connected DVD Player to a Television.

### 10. Reset Button

Use a paperclip or like object to press the Reset Button.

Pressing the Reset Button will restore the bar speaker to it's default settings.

### 11. AC Power Cord (120V/60Hz)

Use the AC Power Cord to connect the bar speaker to standard AC outlet.

### 12. S-Video Output (iPod Only)

*Requires an S-Video Cable.*

Use the S-Video Output to output video from a docked iPod to a Television.

### 13. AV 1 Stereo Audio Inputs

#### AV 2 Stereo Audio Inputs

*Requires a Stereo RCA Audio Cable.*

Use the Stereo Audio Inputs to connect an audio source to the bar speaker, such as a Television, or DVD Player.

### 14. Video 1 and Video 2 Inputs

*Requires a Composite RCA Video Cable.*

Use the Video Inputs to connect a video source to the bar speaker, such as a DVD Player, Digital Cable or Satellite Tuner, Set-Top Box, Gaming Console, or VCR. That video source can then be sent out through the Video Output or S-Video Output to a Television.

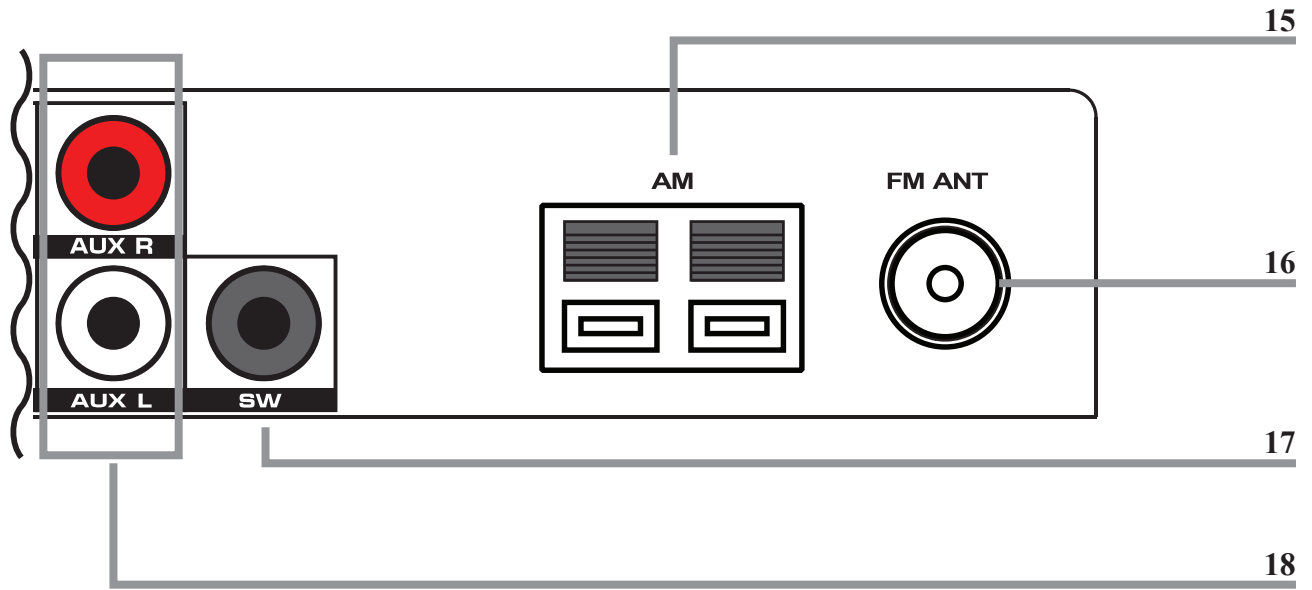

CONTROL GLOSSARY

**15. AM Antenna Connection**

Use the AM Antenna Connection to connect the included AM Loop Antenna to the bar speaker. Connecting the AM Loop Antenna will dramatically improve AM radio reception.

**16. FM Antenna Connection**

Use the FM Antenna Connection to connect the included FM Wire Antenna to the bar speaker. Connecting the FM Wire Antenna will dramatically improve FM radio reception.

**17. Subwoofer Output**

Use the Subwoofer Output to connect an external subwoofer to the bar speaker. This will output all of the lower frequencies that would usually be handled by the bar speaker's internal subwoofer to the connected external subwoofer.

**18. Auxiliary Stereo Audio Inputs**

*Requires a Stereo RCA Audio Cable.*

Use the Auxiliary Stereo Audio Inputs to connect an audio source to the bar speaker such as a DVD Player, Digital Cable or Satellite Tuner, Set-Top Box, Gaming Console, or VCR.

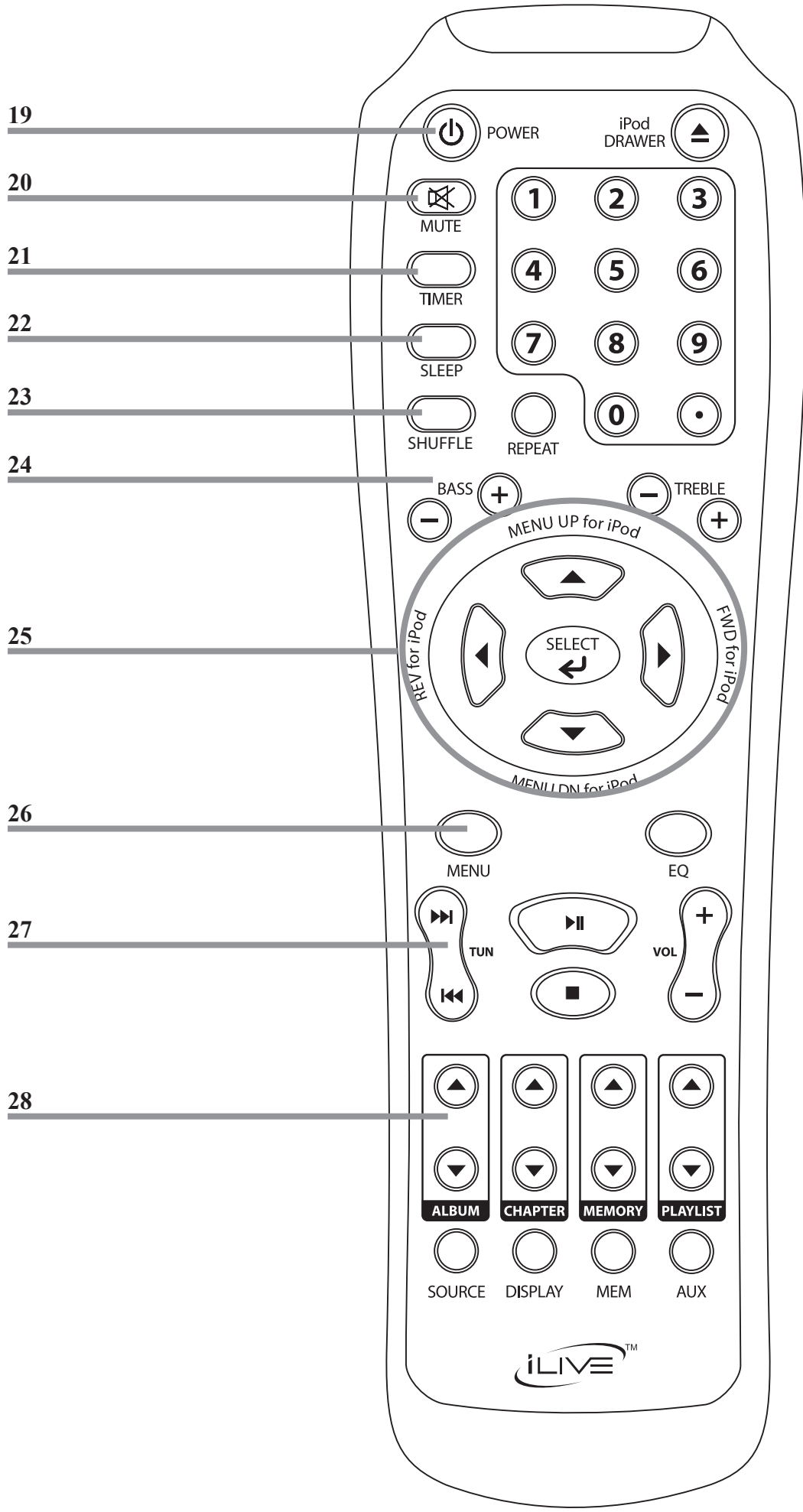

**19. Power Button**

Press the Power Button to turn the bar speaker off and on.

**20. Mute Button**

Press the Mute Button to reduce the volume of the bar speaker entirely.

**21. Timer Button**

With the bar speaker powered off, press the Timer Button to activate or deactivate the timer.

**22. Sleep Button**

Press the Sleep Button repeatedly to set the sleep timer.

*Sleep Timer Settings:*

*90, 85, 80, 75, 70, 65, 60, 55, 50, 45, 40, 35, 30, 25, 20, 15, 10, 05, 04, 03, 02, and 01 minute.*

**23. Shuffle Button**

Press the Shuffle Button to activate the shuffle mode on a docked iPod. When in shuffle mode, the docked iPod will play the current album or playlist in a random order.

Press the Shuffle Button again to deactivate the shuffle mode.

**24. Bass Buttons**

Press the Bass Buttons to adjust the levels of bass output from the bar speaker.

*Bass Settings: -14, -12, -10, -8, -6, -4, -2, 0, +2, +4, +6, +8, +10, +12, +14*

*The Bass can only be adjusted when the EQ Mode is set to Music 2.1 or Music 3.1.*

**25. Menu Up for iPod & Menu Down for iPod Buttons**

Press the Menu Up for iPod and Menu Down for iPod Buttons to move up and down in any of the menus on a docked iPod.

- **Reverse for iPod & Fast Forward for iPod Buttons**

Press the Reverse & Fast Forward for iPod Buttons to skip between tracks or chapters on a docked iPod.

*The Reverse & Fast Forward for iPod Buttons work exactly like the Rewind and Fast-forward Buttons on an iPod.*

**26. Menu Button**

Press the Menu Button to go to the previous menu on a docked iPod.

*The Menu Button on the bar speaker works exactly like the "Menu" Button on an iPod.*

**27. Skip/Tune Buttons**

Press the Tune Buttons to tune the AM or FM radio, when in *AM* or *FM Radio Mode*.

Press and hold the Tune Buttons to scan for the next available AM or FM radio frequency.

Press the Skip Buttons to skip between tracks or chapters on a docked iPod.

**28. Album Buttons**

Press the Album Buttons to cycle through albums on a docked iPod.

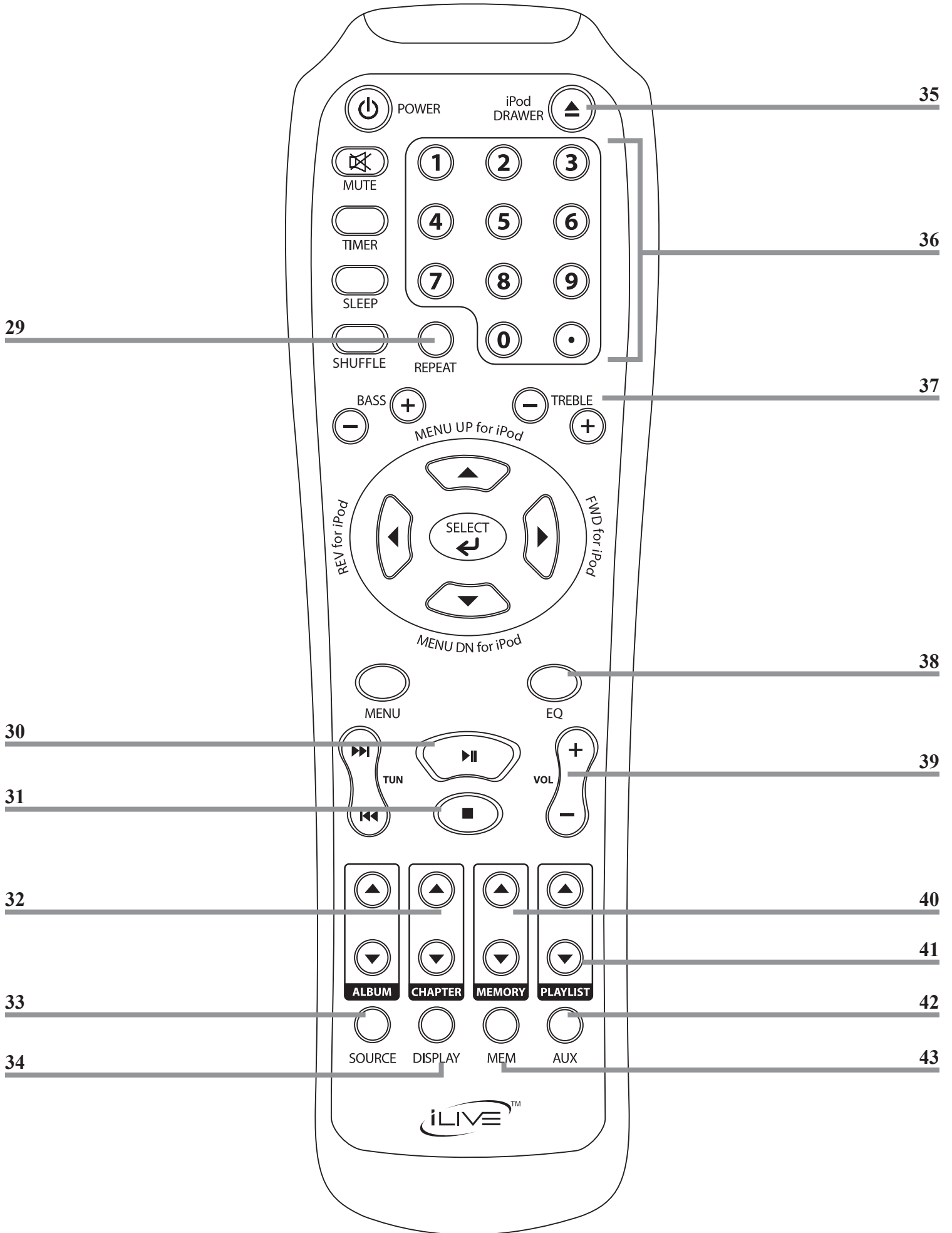



**29. Repeat Button**

Press the Repeat Button to repeat tracks, chapters, albums and playlists, or movies on a docked iPod.

*Press Once:* Repeat the current track or chapter.

*Press Twice:* Repeat the current album, playlist, or movie.

*Press Three Times:* Turn the repeat off.

**30. Play/Pause Button**

Press the Play Button to play a docked iPod.

Press the Pause Button to pause a docked iPod while playing.

**31. Stop Button**

Press the Stop Button to stop a docked iPod while playing.

**32. Chapter Buttons**

Press the Chapter Buttons to cycle through chapters on a docked iPod.

**33. Source Button**

Press the Source Button to switch between the bar speaker's different modes.

- **iPod Mode**  
Switch to iPod Mode to amplify and control a docked iPod.
- **FM Radio Mode**  
Switch to FM Radio Mode to play the FM Radio.
- **AM Radio Mode**  
Switch to AM Radio Mode to play the AM Radio.

**34. Display Button**

In *iPod Mode*, *AM Radio Mode*, or *FM Radio Mode* press the Display Button to view the clock.

**35. iPod Drawer Button**

Press the iPod Drawer Button to open or close the motorized dock for iPod.

**36. Number Keypad****37. Treble Buttons**

Press the Treble Buttons to adjust the levels of treble output from the bar speaker.

*Treble Settings:* -14, -12, -10, -8, -6, -4, -2, 0, +2, +4, +6, +8, +10, +12, +14

*The Treble can only be adjusted when the EQ Mode is set to Music 2.1 or Music 3.1.*

**38. Equalizer Button**

Press the Equalizer Button to adjust the preset equalizer mode.

*See page 15 for details on individual EQ settings.*

**39. Volume Buttons**

Press the Volume Buttons to adjust the volume of the bar speaker.

*Please be responsible when adjusting the volume level of the bar speaker. If the volume is set too high, the audio output from the bar speaker could damage your hearing. Keep the volume in the moderate to low range.*

**40. Memory Buttons**

Press the Memory Buttons to cycle through saved AM or FM radio stations in *AM* or *FM Radio Mode*.

*You can save up to 10 AM and 20 FM stations to the bar speaker's memory.*

**41. Playlist Button**

Press the Playlist Button to cycle through playlists on a docked iPod.

**42. Auxiliary Input Button**

Press the Auxiliary Input Button to cycle through the different audio and video inputs.

- **AV1**  
Plays the source connected to the Audio and Video 1 inputs.
- **AV2**  
Plays the source connected to the Audio and Video 2 inputs.
- **Aux**  
Plays the source connected to the Auxiliary Audio Inputs.
- **Line**  
Plays the source connected to the Line Input.

**43. Memory Button**

Press the Memory Button to save the current AM or FM radio station to the bar speaker's memory.

